

HYBRID STEPPING MOTOR SPECIFICATION

(DIMENSIONS) unit=mm

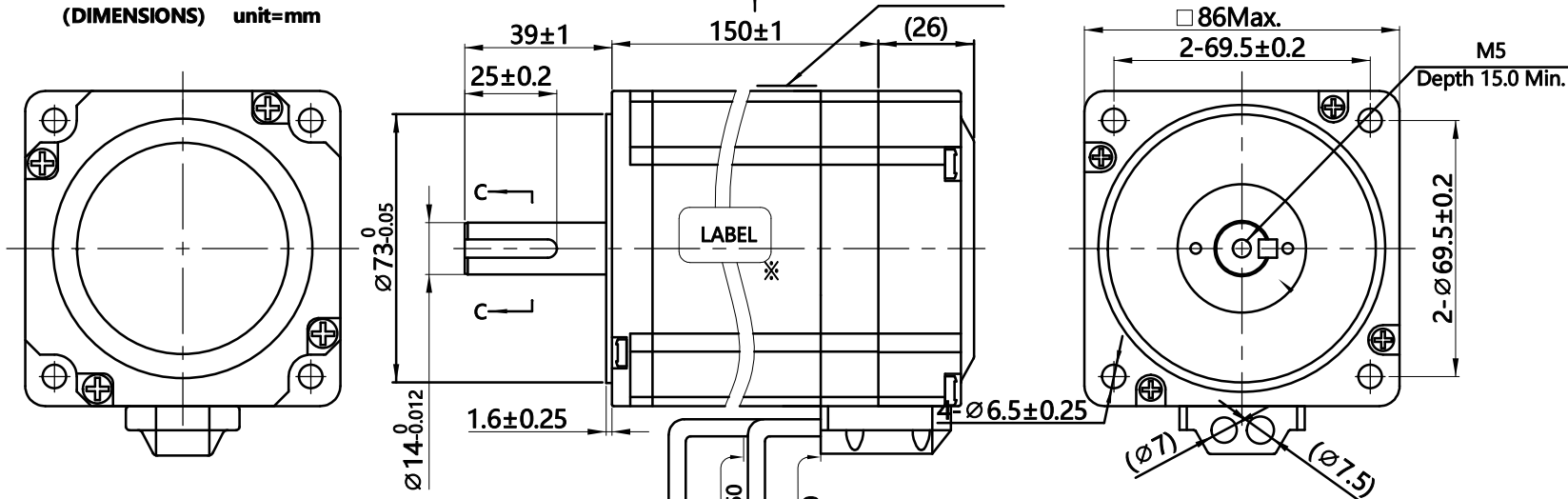

Wiring Diagram

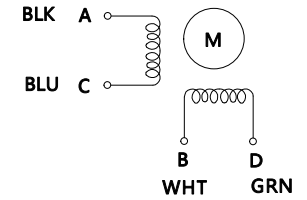

Exciting Sequence vs. Direction of Rotation

STEP	A	B	C	D	Direction
1	+	+	-	-	CCW
2	-	+	+	-	↑
3	-	-	+	+	
4	+	-	-	+	CW

Clockwise view from mounting side

Label Detail

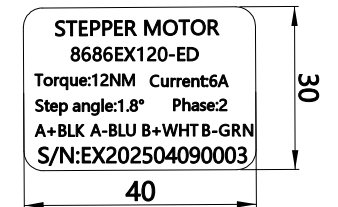

Encoder Pin No.vs.Lead wire color

Pin No.	Color	TTL	DB15 Pin No.	DB15 Pin No.
1	YEL	B+	11	11
2	BLK	A+	1	1
3	RED	Vcc	2	2
4	GRN	B-	12	12
5	BLU	A-	13	13
6	WHT	GND	3	3

Specifications	Comment
12. Step Angle	1.8°±5%
11. Number of Phase	2
10. Rated Voltage	4.14 V
9. Rated Current/Phase	6 A Peak Value)
8. Holding Torque	12 N.M
7. Detent Torque	- g-cm
6. Phase Resistance	0.69 Ω±0.1(20°C)
5. Phase Inductance	7.2 mH±20%(1kHz 1V RMS)
4. Dielectric Strength	AC 500V/ 1min / 5mA Max.
3. Rotor Inertia	2100 g-cm ²
2. Weight	4.5 kg
1. Insulation Class	B (130°) 80K Max.

- Holding torque testing: two phase on/rated current;
- Ambient temperatures : -20°C ~ +50°C;
- Dynamic axial load :34N Max.;
- Dynamic radial load :184N Max. @ 20mm Shaft length 20mm;
- Reliability: MTBF 6000. MTBF 6000 hours or more. @24V/300RPM;
- Encoder: 1000线, 2

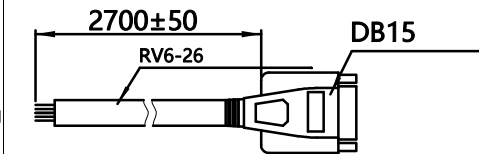

CUSTOMER'S MODELNO. _____ REV. _____

REV.	ECN NO.	REVISION RECORD	DATE	TITLE	STEEPING MOTOR
DESIGN		CHECK		DWG.NO.	86EX120-ED
STANDARD		APPROVE		MATERIAL	
TECHNOLOGY		ECN SIGN		REV.	A
				SCALE	1:2
				SHEET	1 of 1
				SIZE	A4