

HYBRID STEPPING MOTOR SPECIFICATION

(DIMENSIONS) unit=mm

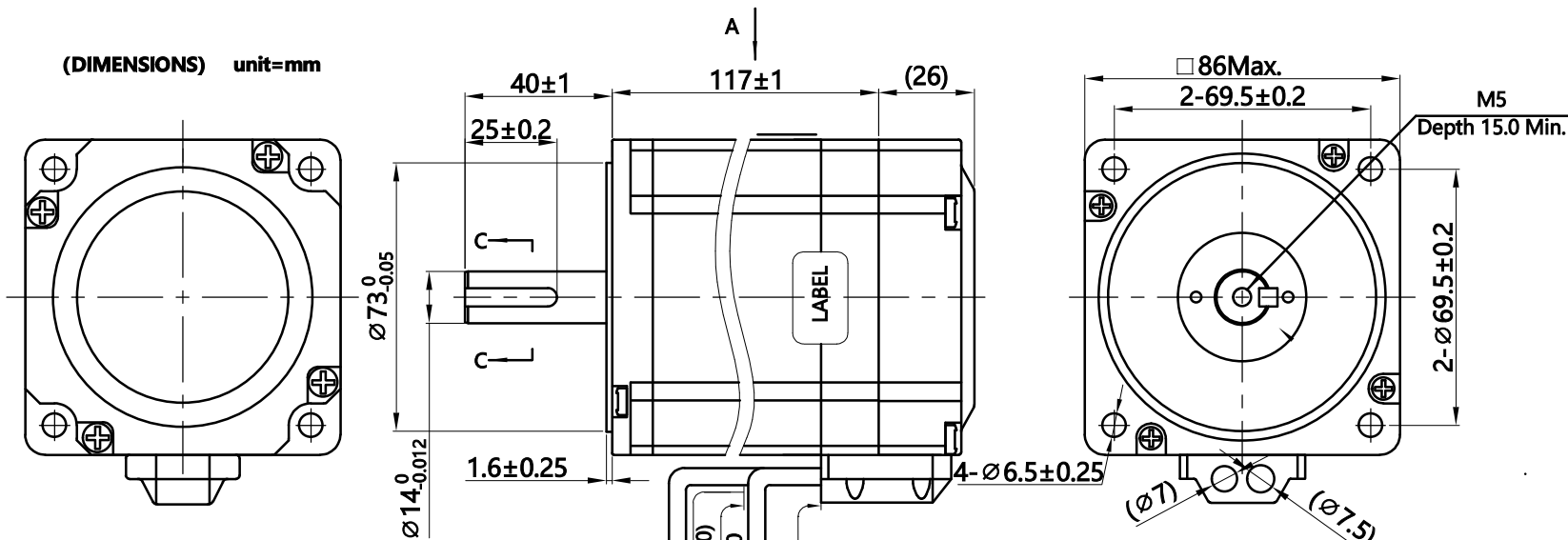

Wiring Diagram

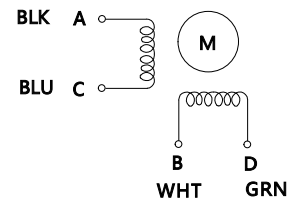

Exciting Sequence vs. Direction of Rotation

STEP	A	B	C	D	
1	+	+	-	-	CCW ↑
2	-	+	+	-	
3	-	-	+	+	
4	+	-	-	+	

Clockwise view from mounting side

Label Detail

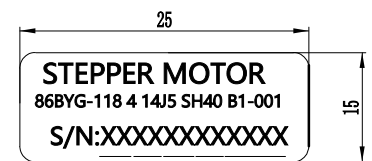

Encoder Pin No.vs.Lead wire color

Pin No	Color	TTL	DB15 Pin No.	DB15 Pin No.
1	YEL	B+	11	11
2	BLK	A+	1	1
3	RED	Vcc	2	2
4	GRN	B-	12	12
5	BLU	A-	13	13
6	WHT	GND	3	3

12, Step Angle	1.8°±5%
11, Number of Phase	2
10, Rated Voltage	2.7 V
9, Rated Current/Phase	6 A Peak Value)
8, Holding Torque	8.5 N.M
7, Detent Torque	- g-cm
6, Phase Resistance	0.45 Ω±0.1(20°C)
5, Phase Inductance	4.75 mH±20%(1kHz 1V RMS)
4, Dielectric Strength	AC 500V/ 1min / 5mA Max.
3, Rotor Inertia	2100 g-cm ²
2, Weight	4.5 kg
1, Insulation Class	B (130°) 80K Max.

Comment

REV.	ECN NO.	REVISION RECORD	DATE	CUSTOMER'S MODELNO.	REV.
DESIGN		CHECK			
STANDARD		APPROVE			
TECHNOLOGY		ECN SIGN			
				TITLE	Closed Loop Stepper Motor
				DWG.NO.	Endox 86EX85 - ED
				MATERIAL	
				REV.	B
				SCALE	1:2
				SHEET	1 of 1
				SIZE	A4