

HYBRID STEPPING MOTOR SPECIFICATION

(DIMENSIONS) unit=mm

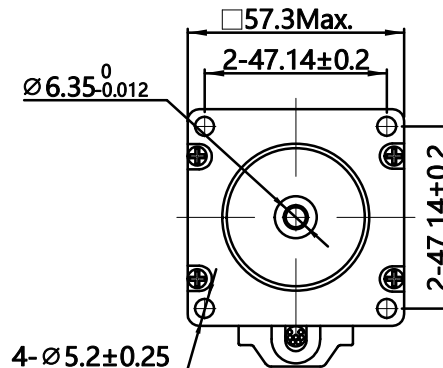

Wiring Diagram

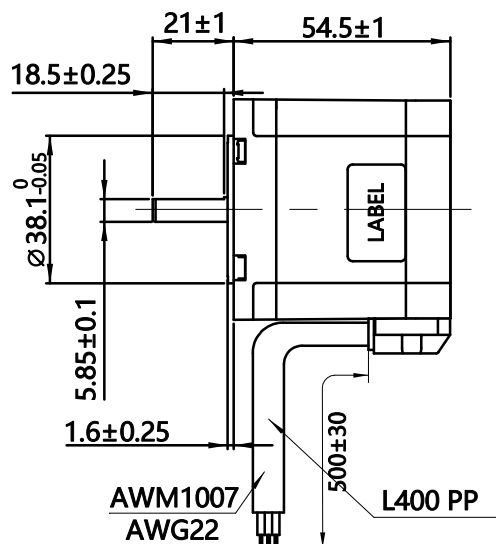
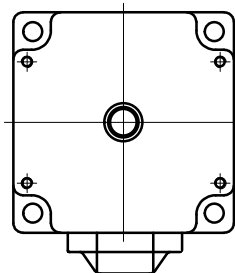
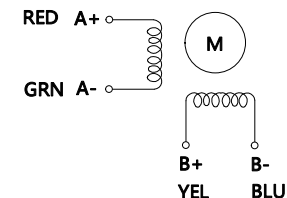

Exciting Sequence vs. Direction of Rotation

STEP	A	B	C	D	Direction
1	+	+	-	-	CCW
2	-	+	+	-	↑
3	-	-	+	+	
4	+	-	-	+	CW

Clockwise view from mounting side

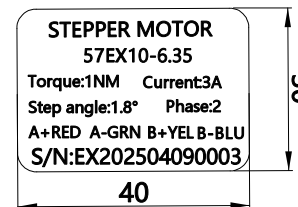

12. Step Angle	1.8°±5%	1. Holding torque testing two phase on/rated current; 2. Ambient temperatures:-20°C~ +50°C; 3. Dynamic axial load :10N Max.; 4. Dynamic radial load :75N Max.@ Shaft length 20mm; 5. Reliability: MTBF 6000. MTBF 6000 hours or more.@24V/300RPM;
11. Number of Phase	2	
10. Rated Voltage	1.2 V	
9. Rated Current/Phase	3 A	
8. Holding Torque	1 N.M	
7. Detent Torque	- g-cm	
6. Phase Resistance	0.4 Ω±0.1(20°C)	
5. Phase Inductance	1.13 mH±20%(1kHz 1V RMS)	
4. Dielectric Strength	AC 500V/ 1min / 5mA Max.	
3. Rotor Inertia	220 g-cm ²	
2. Weight	0.75 kg	
1. Insulation Class	B (130°) 80K Max.	
Specifications		Comment

REV.	ECN NO.	REVISION RECORD	DATE	TITLE	STEPING MOTOR			
DESIGN		CHECK		DWG.NO.	57EX10-6.35			
STANDARD		APPROVE		MATERIAL		SIZE	A4	
TECHNOLOGY		ECN SIGN		REV.	A	SCALE	1:2	SHEET 1 of 1

CUSTOMER'S MODELNO.		REV.	
---------------------	--	------	--